

WareRite Guide to Laminate Countertops



Postform Countertops - page 2
Custom Countertops - page 12
Drawing Guidelines - page 10 & 19
Pricing of Countertops - page 16
Glossary of Terms - page 18
Order Status Terms - page 19

Contact Information

Offices
40 Industrial Drive
East Bridgewater, MA 02333
(800) 323-9405
Fax: (508) 690-2183

Customer Service
Telephone prompt #4
customerservice@warerite.com

Quotes
quotes@warerite.com

Postform laminate tops are factory produced on a ¾" particle board substrate with a one-piece front edge, deck and integrated backsplash. Bar Decks are designed for peninsulas with the edge profile on two parallel sides. Flat Decks are counters with no backsplashes. Postform tops are available with nine different edge profiles: Gothic, Classic, Modern, Renaissance, Valencia, Barcelona, Marbella, Ora, and Geneva, each with specific dimensions as pictured.

Postform tops provide seamless backsplash to nose profile for easy cleanup. Tops are available in thousands of color choices with a "Fast 50" selection in stock for rapid delivery (see page 7).

Gothic Edge

Double Round Over
AKA: Futura, 2300

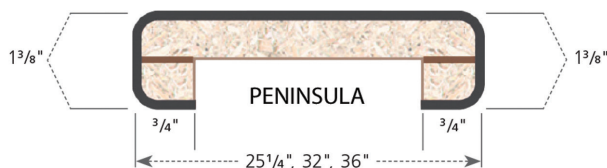
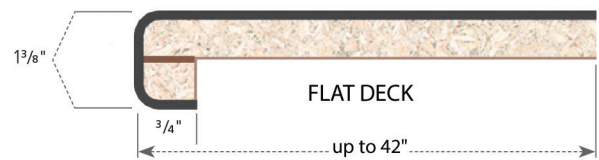

Classic Edge

No Drip
AKA: Caprice, 1000

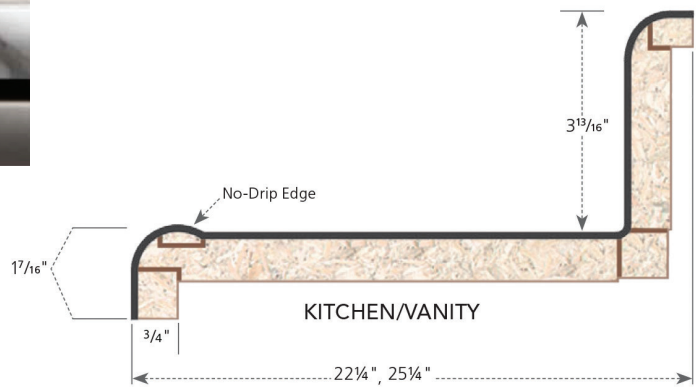
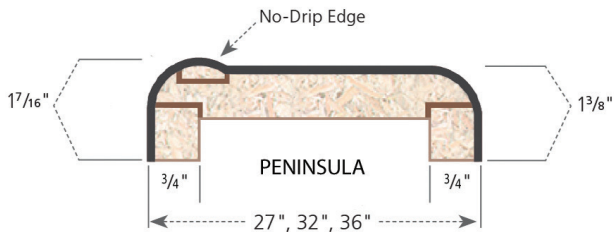
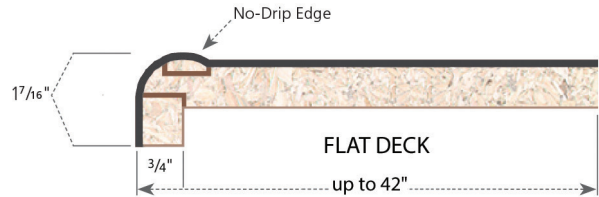

Modern Edge

Waterfall
AKA: Tempo, 1100

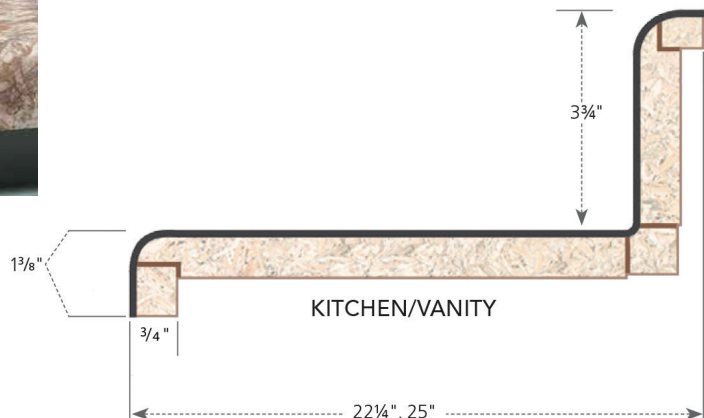
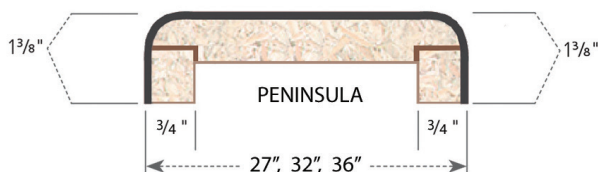
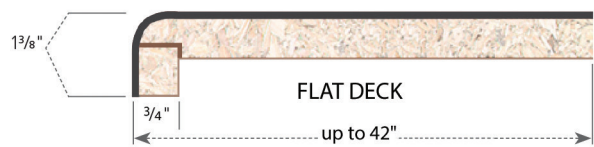

Renaissance Edge

Bullnose
AKA: Nova, 2100

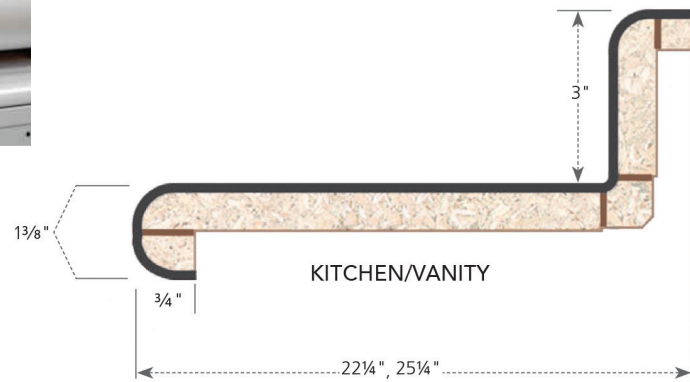
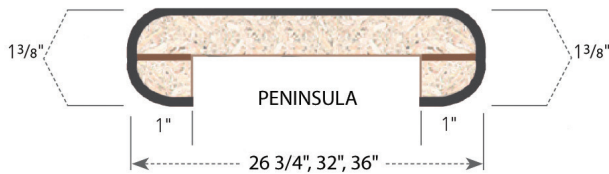

Valencia Edge

Full Wrap Ogee

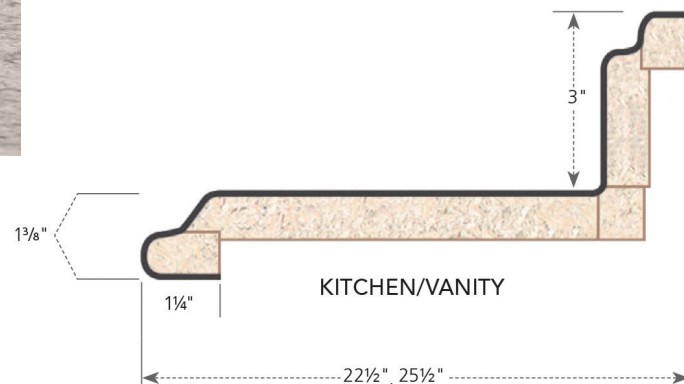
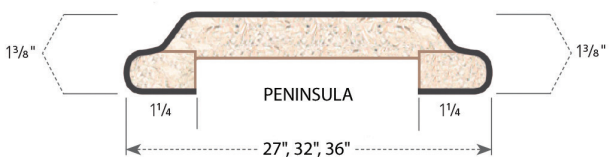
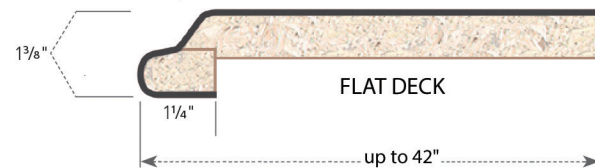

Barcelona Edge
Contemporary Ogee

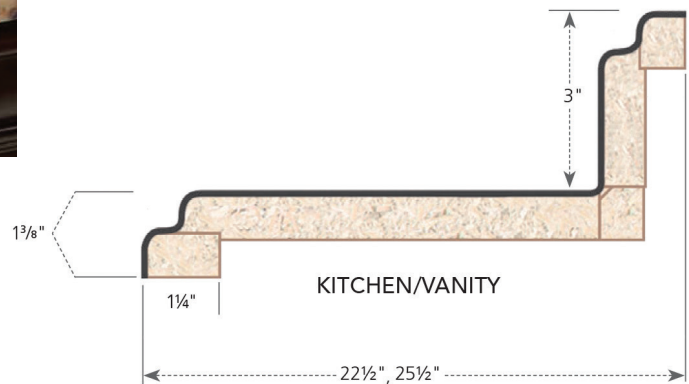
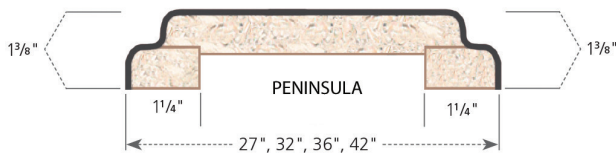
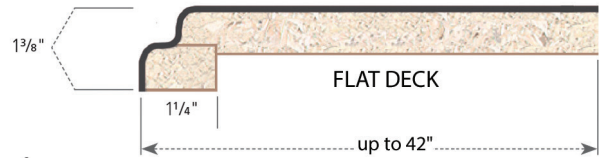

Geneva Edge
Modern Drop Ogee

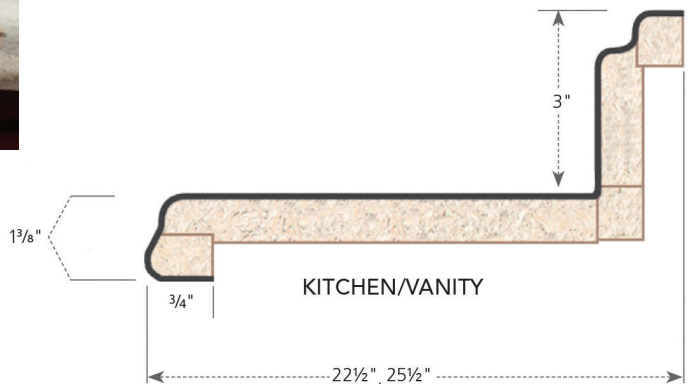
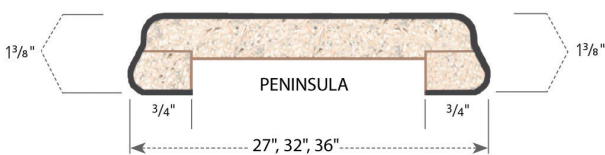

Marbella Edge
Pencil Edge

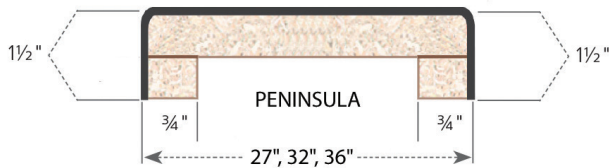
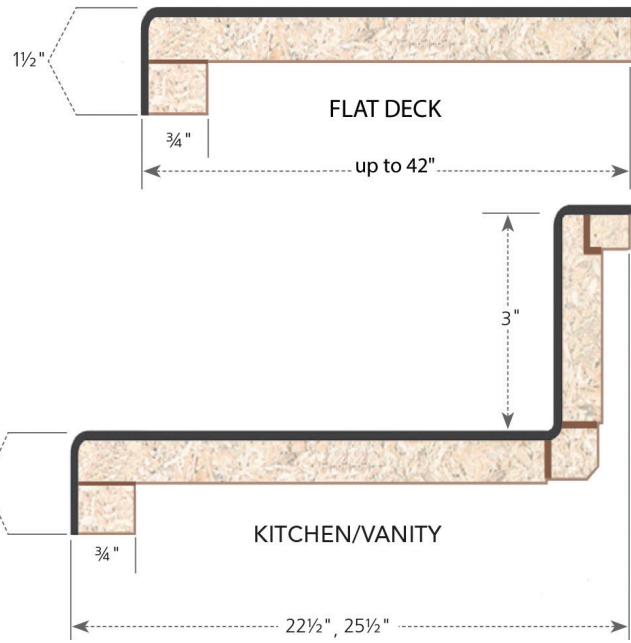

Ora Edge
Double Pencil Edge

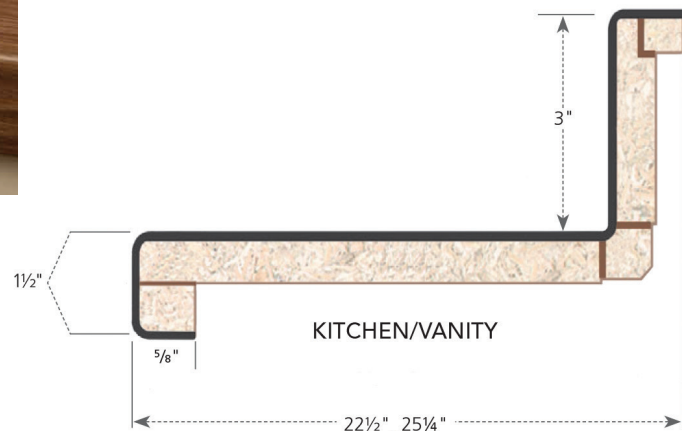
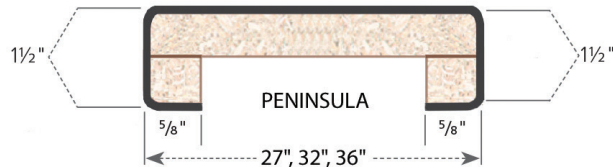
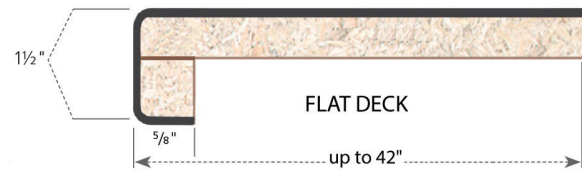
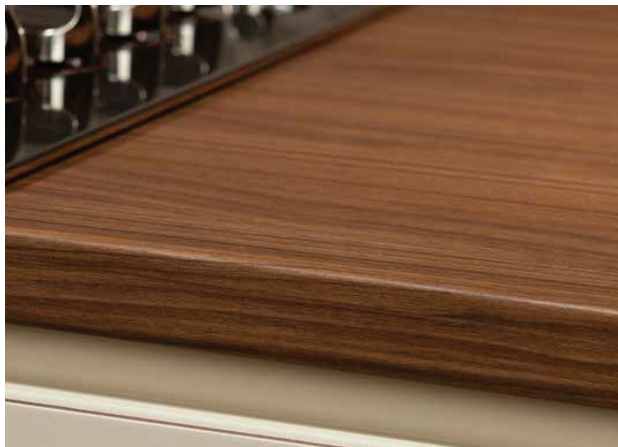

Edge Profile	Kitchen	Vanity	Peninsula	Flat Deck	Backsplash Height
Gothic - Double Round Over	25 1/4"	19 1/4", 22 1/4"	26 1/2", 32", 36"	up to 42"	3"
Classic - No Drip	25 1/4"	19 1/4", 22 1/4"	27", 32", 36"	up to 42"	3 13/16"
Modern - Waterfall	25"	19 1/4", 22 1/4"	27", 32", 36"	up to 42"	3 3/4"
Renaissance - Bullnose	25 1/4"	19 1/4", 22 1/4"	26 3/4", 32", 36"	up to 42"	3"
Valencia - Traditional Ogee	25 1/2"	19 1/4", 22 1/2"	27", 32", 36"	up to 42"	3"
Barcelona - Contemporary Ogee	25 1/2"	19 1/4", 22 1/2"	27", 32", 36"	up to 42"	3"
Geneva - Modern Ogee	25 1/2"	19 1/4", 22 1/2"	27", 32", 36"	up to 42"	3"
Marbella	25 1/2"	19 1/4", 22 1/2"	27", 32", 36"	up to 42"	3"
Ora	25 1/4"	22 1/2"	27", 32", 36"	up to 42"	3"

✓ In WareRite's Stock

Standard Color Group A

Wilsonart	Blackstar Granite (gloss)	4551-01
Formica	Brazilian Brown	6222-58
Formica	Butterrum Granite (matte)	7732-58
Wilsonart	Colorado Slate	7014-58
Wilsonart	Frosty White	1573-60
Wilsonart	Granite	4550-01
Formica	Ivory Kashmir	6226-58
Wilsonart	Milano Amber	4724-60
Wilsonart	Mystique Dawn	4762-60
Wilsonart	Natural Almond	D30-60
Formica	Natural Canvas	7022-58
Wilsonart	Neutral Glace	4143-60
Formica	Sand Stone	7265-58
Formica	Travertine	3526-58
Formica	Tumbled Roca	4835-38
Wilsonart	Venetian Gold	6223-58

Premium Color Group B

Wilsonart	Bahia Granite	4595-52
Wilsonart	Black Alicante	4926-07
Formica	Blackstone (etching)	271-46
Formica	Butterrum Granite (etching)	7732-46
Wilsonart	Café Di Pesco	4955-22
Wilsonart	Calcutta Marble	4925-07
Wilsonart	Garnet Mandura	4921-52
Wilsonart	Italian White Di Pesco	4954-22
Formica	Ivory Kashmir	6226-46
Formica	Jamocho Granite (etching)	7734-46
Wilsonart	Jeweled Coral	4866-52
Formica	Labrador Granite (etching)	3692-46

Premium Color Group B - CONTINUED

Wilsonart	Mandura Gold	4923-52
Wilsonart	Milano Amber	4724-52
Wilsonart	Milano Quartz	4726-52
Wilsonart	Milano Rosso	4891-52
Formica	Ouro Romano	9277-46
Wilsonart	Pearl Mandura	4922-52
Formica	Sand Crystal	3517-46
Wilsonart	Typhoon Ice	4952-52
Formica	Venetian Gold Granite	6223-RD
Formica	White Ice Granite	9476-43

High Definition Color Group D

Wilsonart	Bella Capri	1822-35
Wilsonart	Bella Noche	1820-35
Wilsonart	Bianco Romano	1872-35
Formica	Calacatta Marble	3460FX-46
Wilsonart	Crystalline Dune	1838-45
Wilsonart	Crystalline Shell	1834-45
Wilsonart	Sedona Bluff	1824-35
Wilsonart	Sedona Spirit	1823-35
Wilsonart	Sedona Trail	1826-35
Wilsonart	Spring Carnival	1876-35
Wilsonart	Summer Carnival	1875-35
Wilsonart	Winter Carnival	1874-35

Preparing a Countertop Drawing

Countertops should be drawn to scale showing the desired finished layout. Use the following symbols so that the details of your design are clear to the countertop fabricator.

Finished Ends

Double lines or ticks on the edges indicate finished laminate ends. The front of the counter top is considered finished unless otherwise noted. The sample sketch shows one counter top with a finished left end, right end and Front.



Backsplashes

Parallel lines, along the edges, indicate backsplashes. Backsplashes may be ordered with multiple configurations, Loose, Attached or either with a scribe strip. The sample sketch shows a counter top with a laminate finished front edge and right end, a backsplash along the back wall and an end splash along the left side wall.



Applied Edges

Applied edges can be wood or a laminate profile. Denote the selected edge on the countertop drawing and specify either the wood species and edge detail or the desired laminate edge profile. The sample sketches include two examples. The first is an oak finished front and right side edge. The second has an end cap on the right edge with a cherry wood edged front and a wood edged back and left side splash. Wood edges can be applied before or after the deck laminate is applied. Pre-applied edges are less expensive, but they expose the black line of the laminate edge.

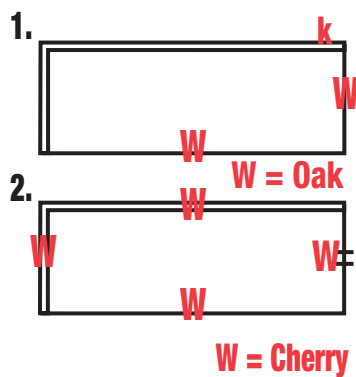

Radius Corners

Radius corners should be drawn out with an “R” and associated measurement to indicate that it is a radius corner and the size desired. The sample sketch shows a counter top with a laminate finished front and right side, a backsplash along the back wall, an end splash along the left side and a radius corner of 3 inches at the right front corner.

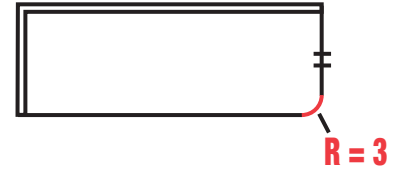

Base End Runs

Base end runs are easier and more accurate if you supply us with the cabinet specifications and we figure out the angle of the cuts.

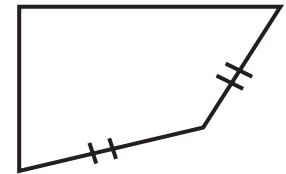

Double Pads

A dotted line with “Double Pad” printed above it indicates double padding should be applied to the bottom of the counter top. You must include the dimension of the desired double pad width. Double padding is typically required when a counter top overhangs a cabinet. The sample sketch shows a counter top with a laminate finished front and sides, two 3” radius corners at the front and double padding 6” deep from the front edge.

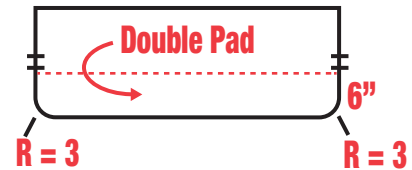

Sink Location

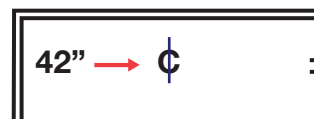

A letter “C” indicates the center line of a sink cutout. It must be accompanied with the distance from the

edge of the countertop to the center of the sink cutout. The designer must supply the dimensions for the rough opening of the sink cut out rough opening, of the sink cut out. The sample sketch shows the counter top with a laminate finished front and right side, a backsplash against the back wall, an end splash along the left side wall and the sink centered at 42” from the left end of the counter top.

Seams

Laminate seams are displayed with a dotted line and accompanying text. A laminate seam is required for any top where the shape or length is greater than the largest piece of laminate available. (144" X 60").

A laminate seam is typically placed at the center of a sink cutout or diagonally at a corner. Seams that are located at or around a sink put the counter top at risk for water damage.

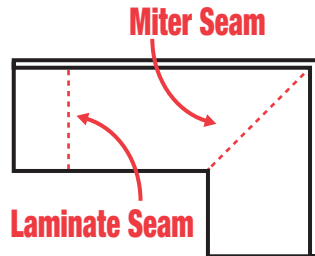

Angle Cuts & Slashes

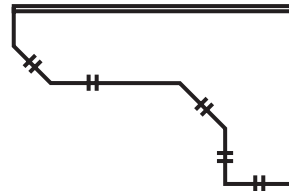

All dimension and angles must be supplied so that the geometry of the countertop can be accurately figured.

Special Counter Tops

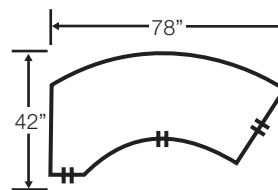

Counter tops with curved walls require a template.

Diagonal Corner Dimensions

These dimensions should always be given from the back wall. NOT the front. The sample sketch has two examples. Drawing #1

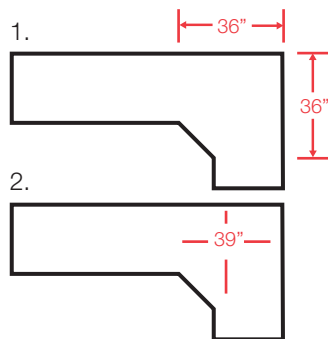

shows the dimensions of the diagonal corner by reference of the back wall. Drawing #2 shows an alternate method to mark a diagonal corner. The dimensions should always be the cabinet's dimensions only.

Joints & Mitres

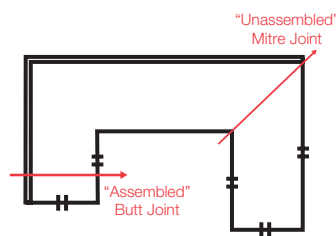

All joints and mitres must be labeled as "Assembled" or "Unassembled". Unassembled butt joints must have their locations measured from the back wall. The

sample sketch shows the counter top with a laminate finish on all but the back wall and left side, a backsplash along the back wall and the left side wall, an unassembled miter joint in the right corner and an assembled butt joint along the left return.

Drop Fronts & Aprons

Drop fronts and aprons are indicated by printing "drop front" or "apron" next to the counter top with arrows indicating which sides will have them. The size of the drop front or apron must be included in the drawing. The sample sketch shows a counter top with a laminate finished front edge and right end, a backsplash along

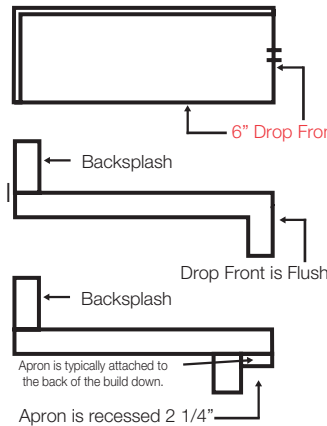

the back wall, an end splash on the left side wall and 6" drop fronts along the front edge and the right end.

Special Considerations for Postform Tops

- RADIUS ENDS: Not recommended, use eased edge in place of radius ends.
- SPLAY CORNER(Diagonal Corner): Only available if sink is to be cut in to the corner
- PLYWOOD DECKS: Are available on post-formed counter tops.

Other Postform Specifics

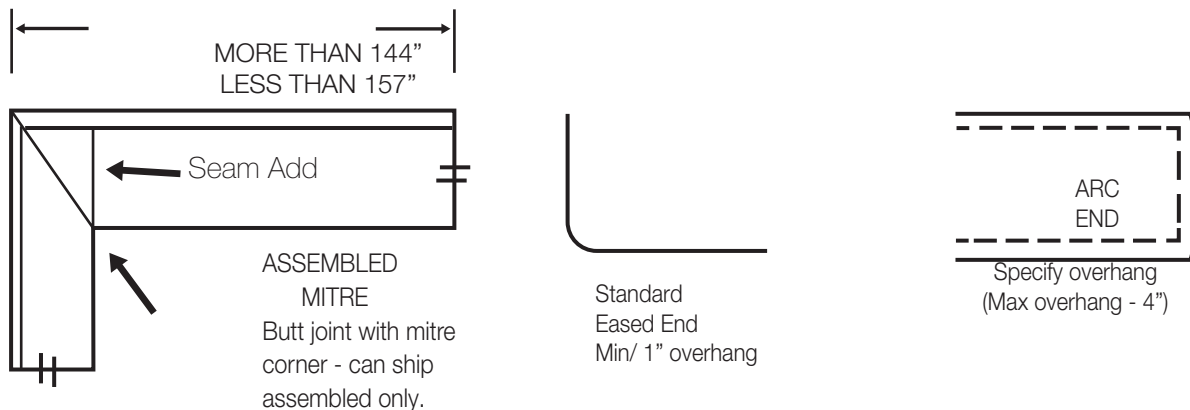
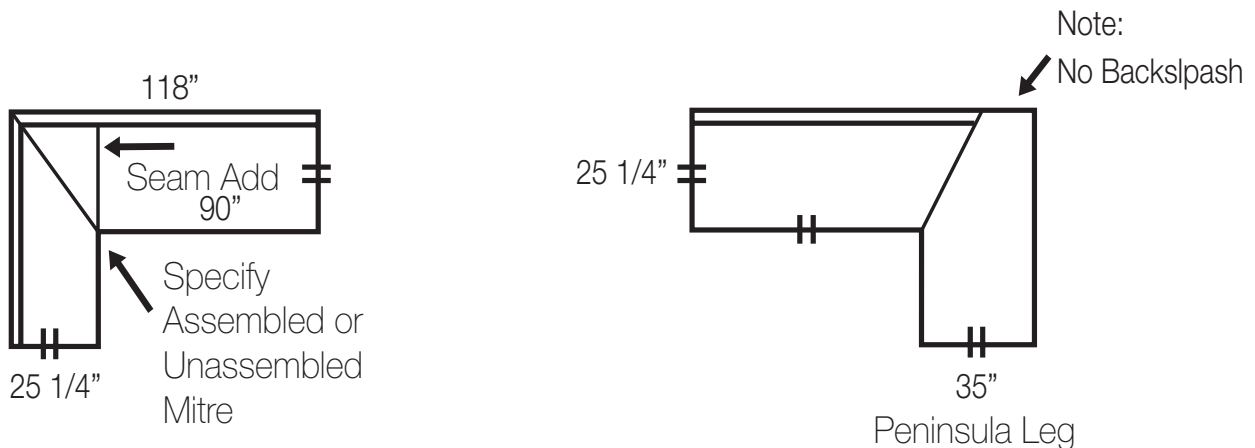

Radius or Clipped Corner Considerations

This is a drawing of a counter top with a standard 1" cabinet overhang. It illustrates that the overhang must be increased based on the size of the radius or clipped corner cuts.

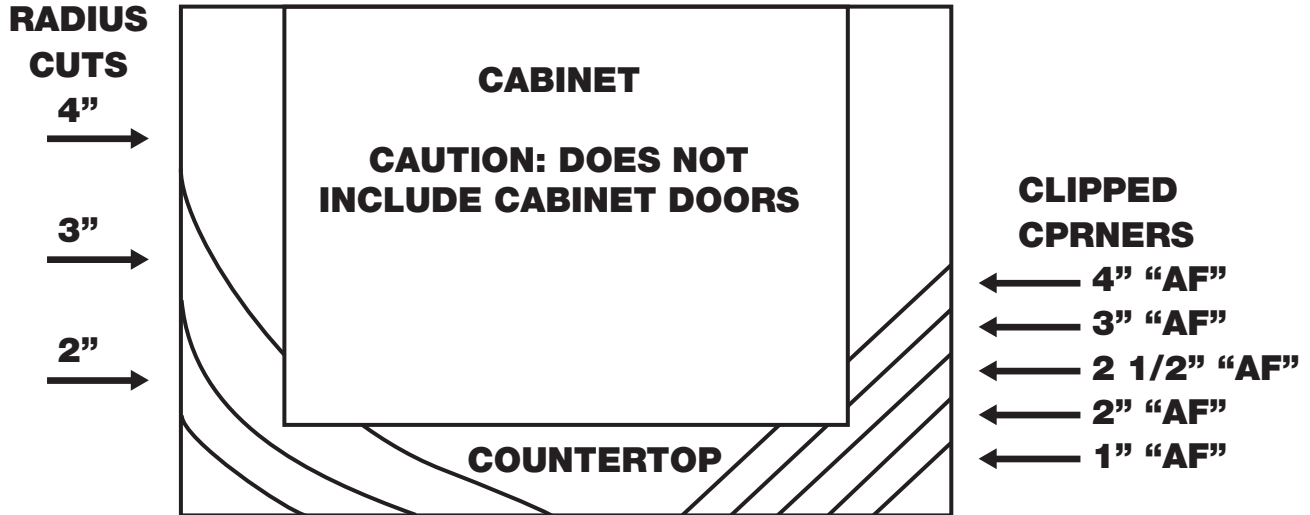

Be sure to allow for additional counter top overhang based on the size of the radius or clipped corner cuts. The following charts provide the recommended counter top overhangs. (Note: Allow extra 3/4" for full overlay door design!)

CLIPPED CORNER		RADIUS	
Clipped Corner Cut Measured Diagonally Across the Face	Recommended Overhang	Radius Cut	Recommended Overhang
1"	1"	2"	1"
1-1/2"	1"	3"	1-1/2"
2"	1-1/2"	4"	1-1/2"
2-1/2"	1-1/2"	5"	2"
3"	1-1/2"	6"	2-1/2"
3-1/2"	2"		
4"	2"		
5"	2"		
6"	2-1/2"		

NOTE: In addition to "Across Face" measurements, clipped corner dimensions can also be made by measuring the distance from what would be the corner of the counter top inward to the desired point that the clip will start.

Custom Countertops are handmade with a $\frac{3}{4}$ " particle board substrate with a $\frac{3}{4}$ " build down making the front edge $1\frac{1}{2}$ " thick. The tops are cut and built to your specifications giving them an almost unlimited design freedom. The laminate edges are applied first and the deck is dropped last so that the deck overlays the edge plastic. Laminate for the deck is supplied in sizes up to 60" X 144" allowing for flexible seam location. Custom tops are available in three edge profiles: Self-Edge, 5/8" Bevel Edge, or Applied Edge.

Self-Edge

Description:

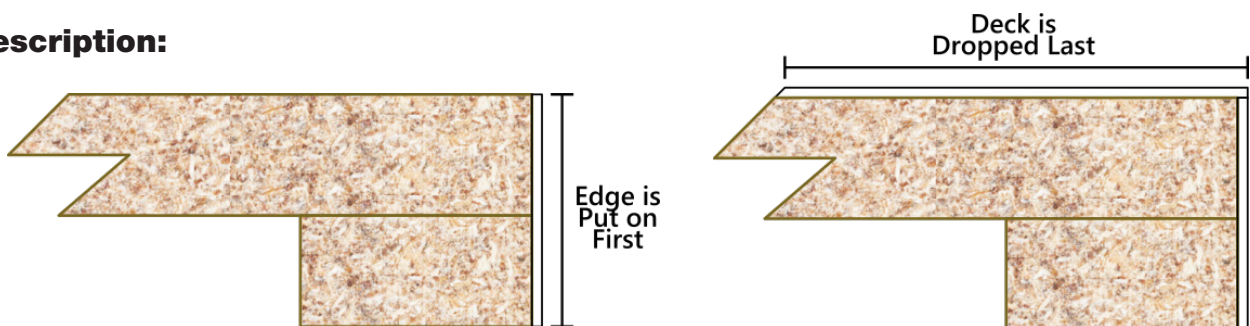

Advantages:

- a. Design Freedom
- b. Variety of strategic seam locations.
- c. Can use different color edge than deck.
(There is no extra charge for a different color edge)
- d. Custom shapes and angles.
- e. Radius, Bullnose, etc.

ARCHITECTURAL DETAILS:

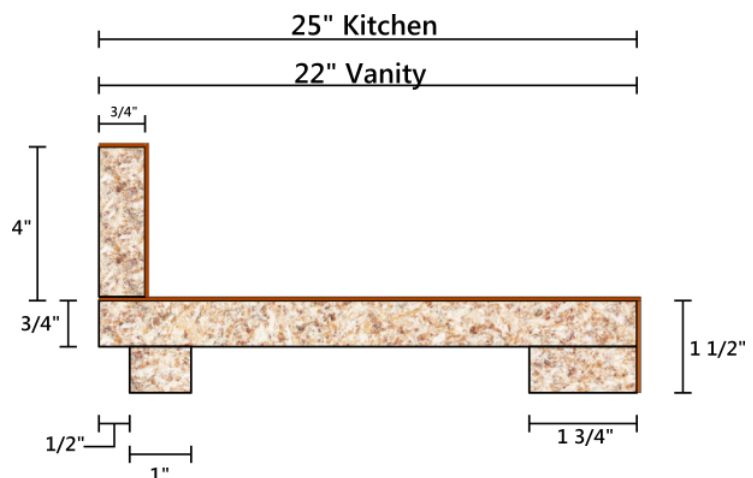

Example shows the standard dimensions. It is important to note that any depth counter can be ordered up to 30" deep with no extra charge. A great plus for European cabinets.

Bevel Edge

Description:

A bevel edge top is a modified square edge top with the edge of the countertop banded with a 5/8" bevel on top. Almost any color combination can be made. **Note:** Only 5/8" bevel available when doing bevel radii.

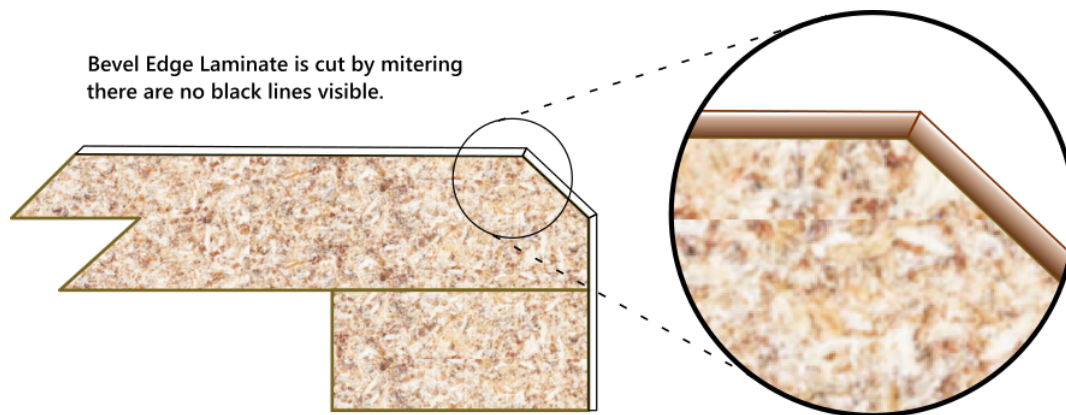

Bevel edge counter tops can create striking design results. Since the bevel edge is created by mitering, there are no black lines. Therefore, solid colors recreate the look of a Solid Surface top at a much lower price. Be Creative.

ARCHITECTURAL DETAILS:

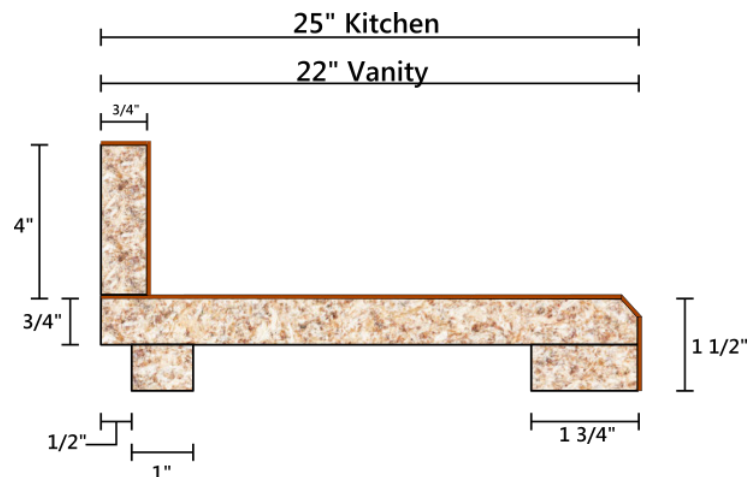

Wood Edge

Woods available: Oak, Cherry, Maple, Red Birch, White Birch, Hickory.

Pre-applied means that a wood edge is applied before the deck is laminated and then a selected edge treatment is routed on the front, this does expose the black line of the laminate. The advantages of pre-applied wood are; it is more water resistant and it costs less. Woods available: Oak, Cherry, Maple, Red Birch, White Birch, Hickory

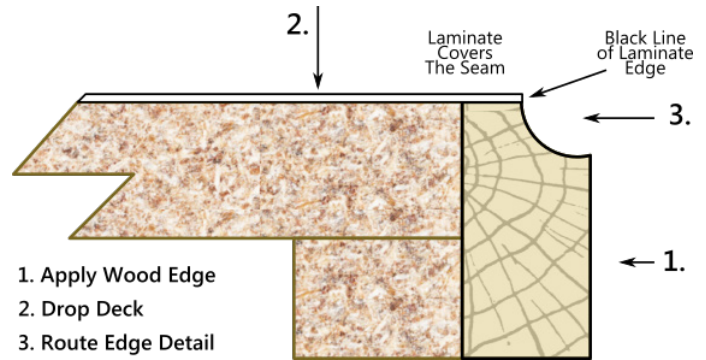

Applied-after means that the deck is laminated first and the wood edge applied after. The edge detail is optional. It can be routed before the wood is applied, or after, whichever fits or works best for the type of edge detail being routed. Applied-after wood is much more time consuming to apply and to mill because of the tongue and groove millwork necessary to insure a quality job. The advantages of applied-after wood are: more wood is exposed, more edge details are possible and no black line. However, applied-after wood is not as water resistant as pre-applied.

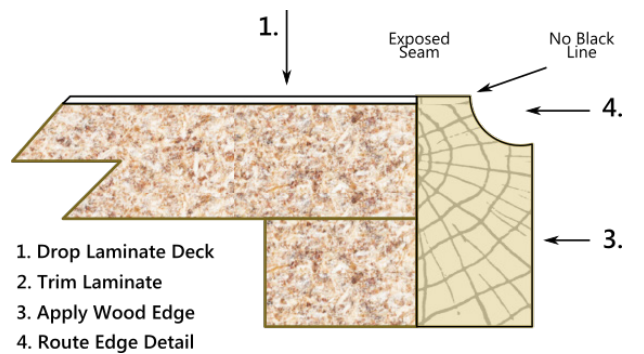

It is important to note that while we have a standard wood species board, you are not limited to those details only.

Be creative, but please be sure to note detail on order. (Example: Applied after wood with a double ogee or double bevel edge detail) Wood edge also can be applied to the back splash for a premium charge.

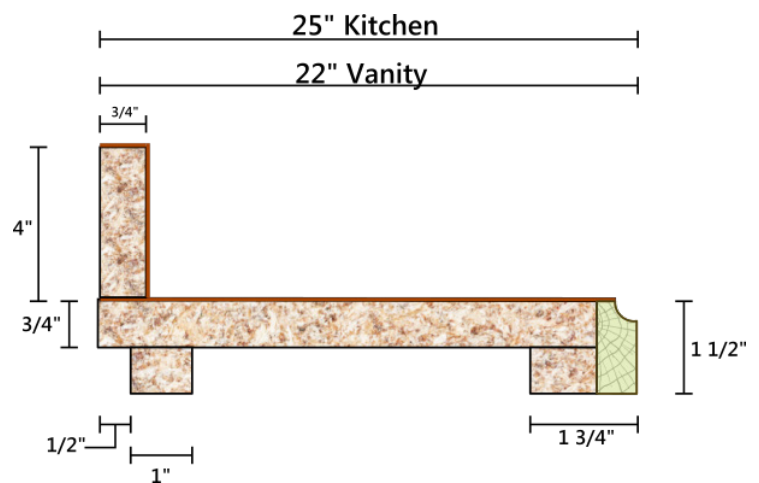

Laminate Edge

Applied laminate edges are manufacturer-specific profiles as shown. The deck is laminated first then a matching decorative edge is applied to transform the top into a sculpted architectural design. The razor-sharp profile on the edge eliminates the visible laminate seam creating the appearance of a solid countertop that mimics the look of more expensive granite or quartz. Laminate edges are flexible so that they can be formed into gently arched counters if desired.

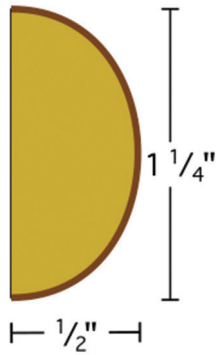
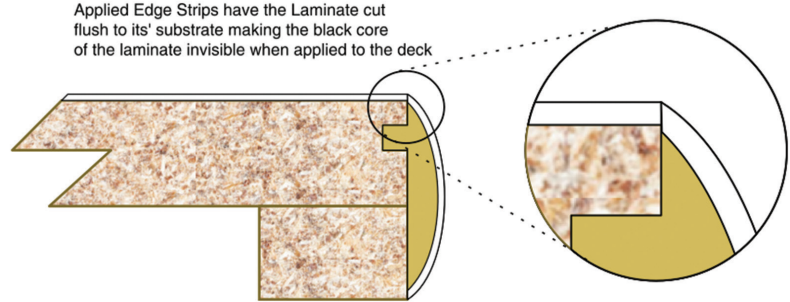

**FORMICA
BULLNOSE**

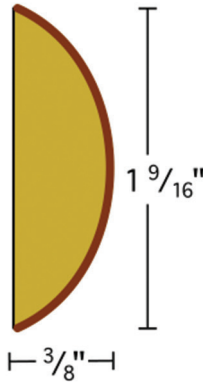

**WILSONART
CRESCENT**

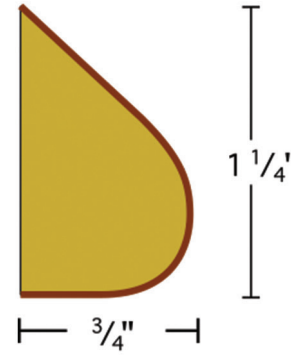

**FORMICA
OGEE**

Architctural Details

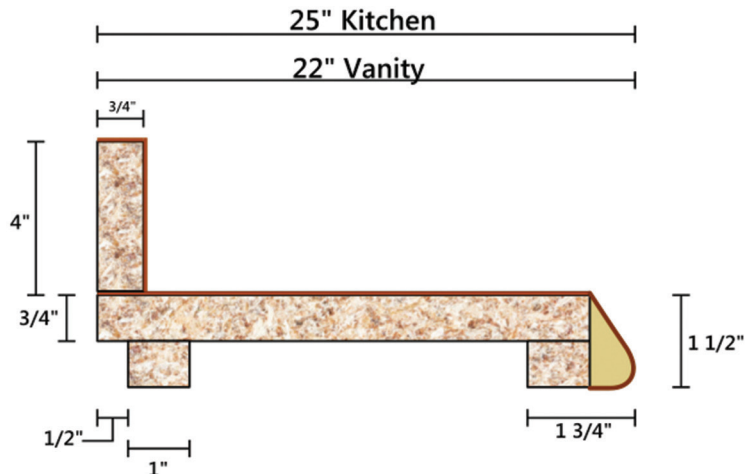

Special Considerations for Custom Tops

- Use the following design symbols to clearly communicate your design to the fabricator.

Base angled cabinets: Proper information needed —

1. Cabinet Run
2. Cabinet Spec
3. Amount of Overhang

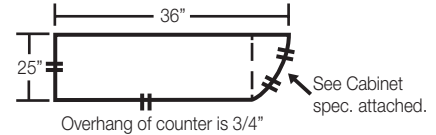
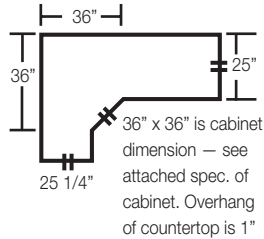

Cut-back or bump-out: When depth of counter top is “cut-back” to a smaller depth or “bumped-out” to a larger depth. Proper information needed --

1. Cabinet Run
2. Cabinet Spec
3. Amount of Overhang

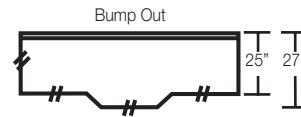
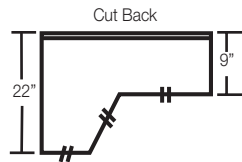

Bullnose end: When the overhang dimension is 1/2 of the depth of the deck.

Arc end: When the overhang dimension is less than 1/2 of the depth of the deck.

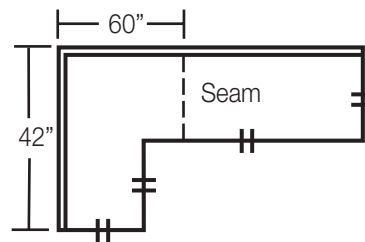
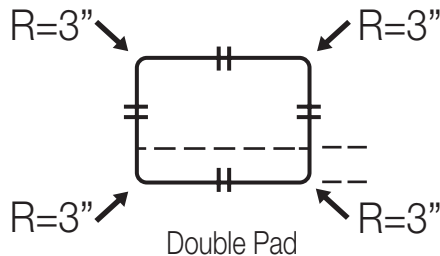
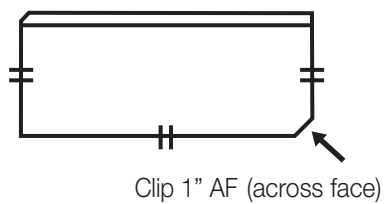
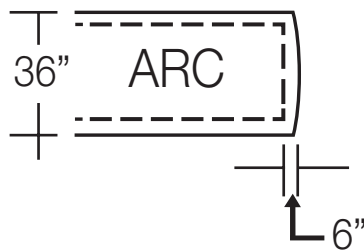

Laminate tops are available as Fabricated and Delivered or Template and Installed products and are priced accordingly. Pricing is calculated either on a linear inch or square foot basis. The edge profile as well as the laminate color combine to define the price point. There are three price levels for laminate as determined by the two numbers following the dash in the stock number as follows:

Price Group	Wilsonart	Formica
A	38, 60	43, 58, NT
B	01, 07, 12, 18, 22, 52	34, 42, 46, WR, RD
D	35, 45, 55	FX34, FX46, FX77, FXNG, FXRD,

Calculation Methods

- Linear – measure overall length along back wall
- Square Foot – deduct corner overlap between adjacent legs
- Back Splash – Be sure to add square footage of backsplash

Ware Rite offers a wide range of custom fabricated options. Ensure that the cost of these options is added to the cost of your countertop based on your Warerite price list. Contact Ware Rite Customer Service for other options you want. Some commonly requested options are:

- Bevel Edge Radius (min. 2")
- Bevel or Applied Edge Clip or Angle Cut
- Wood Edge Radius (min. 2")
- Wood Edge Arc or Bullnose End
- Postform Splay Corner (must include a sink)
- Bevel or Wood Edge Added to Backsplash, priced per LF
- Water Guard Backsplash, priced per LF
- Custom Backsplash Attached to Deck, priced per LF
- Support Legs
- Support Brackets

If you are requesting that Ware Rite template and install your top, add these charges to the countertop cost calculated above.

ARC END

An arc end is the curved arched end applied to the end of a peninsula or island countertop. The size of the arch is determined and can be limited by the amount of overhang from the cabinet. A top must have a minimum of 3" overhang.

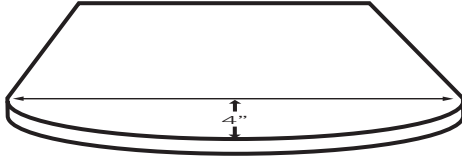

BACKSPLASH

Refers to the vertical portion of the countertop.

BLANK

A pre-laminated straight length of countertop. The term is typically used to represent stock post-formed countertops.

BUILD UP

This is a strip of core material applied to the underside of a deck before a cap is applied.

BUTT JOINT or FIELD JOINT

This joint is used to join two straight pieces of post-formed blanks when a countertop's length exceeds 144". The location of the butt joint is required on all drawings. You should consider an alternative before using; this type of joint is not recommended or guaranteed by WareRite.

CLIP CORNER

A clip corner is a corner with a 45° cut off the front. This is used to soften the corner. Use this where corner sweep is impractical. You must allow a minimum of overhang for a 2" x 2" clip. See page 14 for limitations and considerations.

COVE

This is the formed joint between the deck and the backsplash in post-formed tops.

DECK

Refers to the flat horizontal portion of the countertop.

EASED END

An eased end is a slight bend at the front corner of an open end of a counter. It is used to soften the corner. You must have a least 1" of overhang from the cabinet. Please note, the angle that results at the front end of the corner will result in a wider and more noticeable showing of the black line of the laminate.

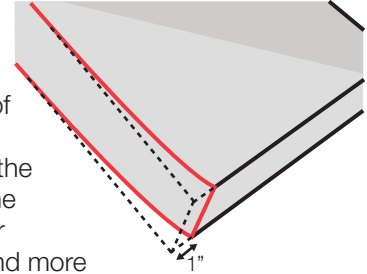

END CAP

This is the laminate applied to the end of a countertop to finish the end.

END SPLASH or SIDE SPLASH

An endsplash or sidesplash is a backsplash that is used at the end of a countertop up to a side wall.

The example below is of a Post-Formed Classic end splash. The Classic edge style is the only one where the end splash drops down across the front of the deck.

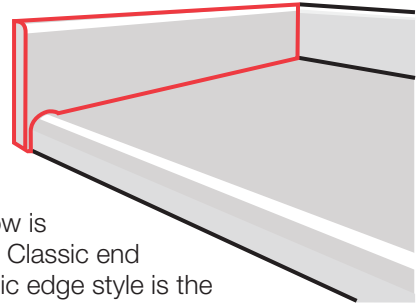

Kitchen/Vanity

Postformed tops with front edge and included backsplash

Peninsula

Straight tops finished with the specified edge profile on two parallel sides. If visible the unfinished sides require an end cap.

FLAT DECK

A flat deck is a countertop, without a backsplash.

Peninsula

Straight run tops, finished on two parallel sides with the selected edge. The ends are unfinished and if visible require an applied end cap.

LAMINATE SEAM

This is a seam that is required when the shape or size of the top exceeds the dimension of the un-cut sheet of laminate. The largest piece of laminate is 144" x 60". The location should be determined by the designer and included in all drawings. WareRite does not recommend the seam be placed in or around a sink area.

MITRE BOLTS

These are specialized bolts used to hold mitre joints together. The standard is to use four bolts per mitre.

MITRE JOINT

This is the joint used with post-formed tops when turning a corner a 90° angle. This joint may be assembled at the factory or left unassembled for assembly on site.

MITRES BUTT JOINT

This joint is used to extend the length of a post-formed counter top beyond 144" but less than 157" when creating a 90° corner.

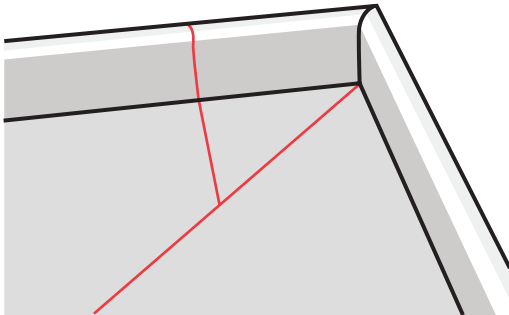

order basis at a premium.

PARTICLE BOARD

particle board is the substrate use for most counter tops. It should be at least a 45 to 47 lb. medium density. WareRite can also supply plywood substrates on a special order basis at a premium.

PLASTIC LAMINATE

This is a general term used to reference materials such as "FORMICA", "WILSONART", "NEVAMAR", etc.

RADIUS CORNER

A radius corner is a rounded corner at the front of an open end of a counter top.

SCRIBE

This is an extension of core materials and laminates on the top and rear of backsplashes. It is used by an installer to fit the counter top with backsplash to an irregular wall.

Ware Rite provides an ORDER STATUS report designed to keep our customers updated on all current open orders. The following is a list of status definitions used in the report.

NEW While in the order entry screen, an order gets a new status when the header information has been entered, but the details have not. Orders should only be in this status during the order entry process. Orders left in this status have not been completed properly. This is an automatic status set by the computer.

PRNT Once the order details have been entered and saved by the customer service rep, the computer automatically puts the order into this status.

PREO This is the Pre-Order status. The purchasing department may place several orders into this status while they are evaluating materials to be purchased. If an order remains in this status after the purchasing process, the purchase process is not considered complete. If an order remains in this status for more than a day, your Customer Service Representative should be contacted immediately.

ORDR An order will be placed in this status if it requires materials that need to be purchased and all materials have been allocated to a purchase order. The order will leave this status when the Purchase order it's allocated to is complete and ordered.

PURC This is the purchase status. The computer automatically sets it once a purchase order has been built and sent to the vendor.

SUSP Orders are placed in this, the suspense status, manually by order entry, customer service or purchasing due to a question on an order. To be removed from this status, the order must be updated and have all questions answered.

ETA The computer sets this status when material due on a purchase order is not received by the expected date. It means that a new ETA, estimated time of arrival, needs to be determined and set by WareRite after follow through with our vendor.

PART An order should only be in this status if, prior to this, it was in the ETA status and all ETAs for all materials have been set. The computer automatically sets this status.

RECD This status, the received status, is automatically set by the computer when all the materials required to manufacture and complete an order are in stock or have been received. SHOP An order is placed in this status when a work order has been scanned in the shop designating this order for staging and production.

DOCK An order is placed in this status automatically when all items have been scanned into finished goods inventory. The order is complete and waiting shipment to the customer or dealer.

IDOC This status is the same as the DOCK status in that all items have been scanned into finished goods inventory. This order though is scheduled to be installed by WareRite.

TRAN This status, the transported status, is automatically set when all items have been scanned and loaded on a truck for delivery.

ACCE This status, the Accepted status, is set after delivery or installation. It represents the acceptance of the documentation and proof of delivery by Accounts Receivable and is the final status prior to Invoicing. IND 2008.2